

Nice shell.



Round & Diamond Locating Pins Now Available With LIFE-EX™ Coating

Made from a proprietary PVD coating,
LIFE-EX™ Locating Pins are very hard, abrasion resistant, and slippery.

The result is a component that has a longer lifecycle for high-production applications.

LIFE-EX™ coating from Carr Lane Manufacturing extends the lifecycle of your locating pins, allowing them to remain in production longer with less need for replacement than standard uncoated items.

LIFE-EX™ Locating Pins from Carr Lane will have you saying, "That's one shell of a coating!"

CarrLane[®]

MANUFACTURING CO.

carrlane.com 314.647.6200

Locating Pins with LIFE-EX™ coating!

Many sizes of Round & Diamond Pins are now available with our proprietary LIFE-EX™ coating. This PVD coating is very hard, abrasion resistant, and slippery, resulting in a component that has a longer lifecycle for high-production applications. This extended lifecycle allows these items to remain in production longer with less need for replacement than standard uncoated items.



Round Pin

LIFE-EX™ ROUND PINS (INCH)

PART NO.	A HEAD DIA		B SHANK DIA		C	D	E
	NOMINAL	ACTUAL	NOMINAL	ACTUAL			
CL-2-RP-LX	5/16	.3120/.3117	1/4	.2503/.2501	13/32	3/32	7/8
CL-3-RP-LX	3/8	.3745/.3742	5/16	.3128/.3126	1/2	1/8	1
CL-5-RP-LX	1/2	.4995/.4992	7/16	.4378/.4376	21/32	5/32	1-3/8

LIFE-EX™ ROUND PINS (METRIC)

CLM-80-RP-LX	8mm	.3145/.3142	6mm	.2365/.2363	13/32	3/32	7/8
CLM-100-RP-LX	10mm	.3932/.3929	8mm	.3153/.3151	1/2	1/8	1
CLM-120-RP-LX	12mm	.4719/.4716	10mm	.3940/.3938	21/32	5/32	1-3/8

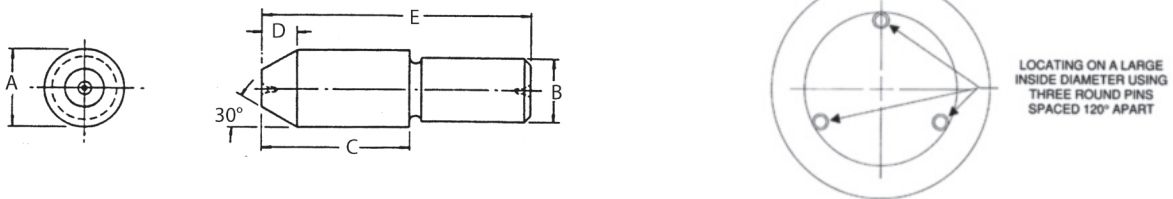

Diamond Pin

LIFE-EX™ DIAMOND PINS (INCH)

PART NO.	A HEAD DIA				B SHANK DIA		C	D	E	F
	X (Tight)	NOMINAL	X	Y	Z	NOMINAL				
CL-2-DPX-LX	5/16	.3118/.3115	.3110/.3107	.3095/.3092	1/4	.2503/.2501	13/32	.078	3/32	7/8
CL-3-DPX-LX	3/8	.3743/.3740	.3735/.3732	.3720/.3717	5/16	.3128/.3126	1/2	.093	1/8	1
CL-5-DPX-LX	1/2	.4993/.4990	.4985/.4982	.4970/.4967	7/16	.4378/.4376	21/32	.125	5/32	1-3/8

LIFE-EX™ DIAMOND PINS (METRIC)

CLM-60-DPX-LX	6mm	.2357/.2354	.2347/.2344	.2332/.2329	5mm	.1972/.1970	11/32	.062	3/32	3/4
CLM-80-DPX-LX	8mm	.3145/.3142	.3135/.3132	.3120/.3117	6mm	.2365/.2363	13/32	.078		7/8
CLM-100-DPX-LX	10mm	.3932/.3929	.3922/.3919	.3907/.3904	8mm	.3153/.3151	1/2	.093	1/8	1

